

# MEO Engineering Company, Inc.

High Tech on Small Scale Since 2004

## GALEX™ Instruments Sample Temperature Control Peltier Stage for FIB/SEM

### DESIGN HIGHLIGHTS

- Desktop or rack-mountable controller, push-button operation or computerized GUI control
- Integration with GALEX GIS or stand-alone operation

### Design Specifications:

Cooling below  $-50^{\circ}\text{C}$   
Heating above  $+180^{\circ}\text{C}$   
Cooling control  $0.1^{\circ}\text{C}$   
Heating control  $1^{\circ}\text{C}$

### Design Highlights:

- Compatible with all FIB/SEM instruments from any OEMs
- Compatible with vented-chamber and load-lock systems
- Compatible with standard sample holders
- Fast settling of temperature
- Patent-pending rapid sample exchange
- Patent-pending three-stage cooling
- Heating/cooling mode on the same device
- Compact and lightweight

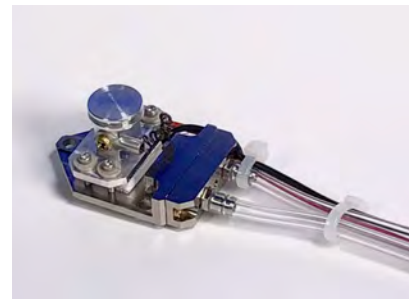
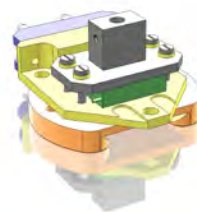
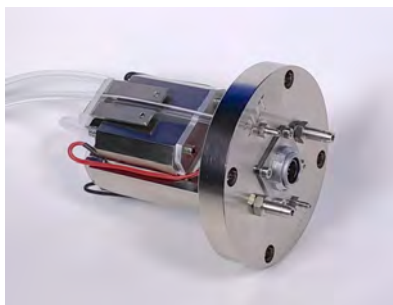

MEO Engineering Company  
290 Broadway, Suite 298  
Methuen, MA 01844, USA  
Phone: +1-978-305-0479  
E-mail: [vray@partbeamsystem.com](mailto:vray@partbeamsystem.com)  
Web: [www.freudlabs.com](http://www.freudlabs.com)

Patent Pending. Available for demo in Q1 2019.